



MARINE
RIGGING SYSTEM

SWAGELESS THREAD TERMINALS METRIC

High Polished Stainless Steel - AISI 316

ART. NO RIGHT	ART. NO. LEFT	WIRE	THREAD G	L1	L2	L3	KW1	KW2	BL	KG/100
800305	810305	3	M5	79	58	42	10	12	750 KG	4,2
800306	810306	3	M6	85	63	47	10	12	750 KG	4,5
800406	810406	4	M6	92	63	47	12	14	1500 KG	5,6
800408	810408	4	M8	102	72	57	12	14	1500 KG	6,6
800508	810508	5	M8	111	78	57	13	16	2180 KG	9,0
800510	810510	5	M10	117	84	63	13	16	2180 KG	10,0
800610	810610	6	M10	128	90	63	16	19	3700 KG	15,0
800612	810612	6	M12	145	107	80	16	19	3700 KG	17,0
800712	810712	7	M12	153	110	80	18	22	4700 KG	22,0
800714	810714	7	M14	162	119	89	18	22	4700 KG	25,0
800812	810812	8	M12	162	113	80	19	24	5600 KG	28,0
800814	810814	8	M14	171	122	89	19	24	5600 KG	31,0
800816	810816	8	M16	182	133	100	19	24	5600 KG	40,0
801016	811016	10	M16	190	139	100	24	27	8300 KG	48,0
801220	811220	12	M20	227	159	120	27	32	12000 KG	79,0
801422	811422	14	M22	264	191	140	30	36	17000 KG	124,0
801624	811624	16	M24	308	227	170	32	41	23000 KG	175,0

Note: All breakloads are determined by wedges (jaws) and thread
The user is responsible for choosing the proper cable diameter and for correct assembly

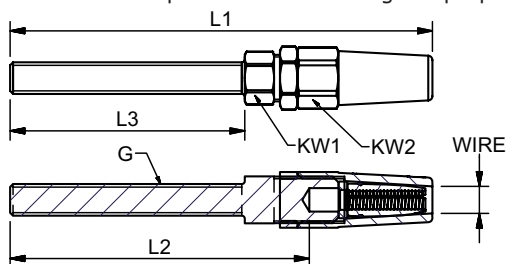

SWAGELESS THREAD TERMINALS UNF

High Polished Stainless Steel - AISI 316

ART. NO. RIGHT	ART. NO. LEFT	WIRE	THREAD G	L1	L2	L3	KW1	KW2	BL	KG/100
800306A	810306A	3	1/4"	85	63	47	10	12	750 KG	4,5
803206A	813206A		1/8"	85	63	47	10	12	750 KG	4,5
800406A	810406A	4	5/32"	92	63	47	12	14	1500 KG	5,6
800408A	810408A	4	5/32"	102	72	57	12	14	1500 KG	6,6
804708A	814708A		3/16"	111	78	57	13	16	2150 KG	9,0
800508A	810508A	5	5/16"	111	78	57	13	16	2180 KG	9,0
800510A	810510A	5	3/8"	117	84	63	13	16	2380 KG	10,0
805510A	815510A		7/32"	128	90	63	16	19	3000 KG	14,0
805511A	815511A		7/32"	133	95	68	16	19	3000 KG	14,3
805512A	815512A		7/32"	145	107	80	16	19	3000 KG	17,5
800610A	810610A	6	3/8"	128	90	63	16	19	3700 KG	15,0
800611A	810611A	6	7/16"	133	95	68	16	19	3700 KG	15,0
800612A	810612A	6	1/2"	145	107	80	16	19	3700 KG	17,5
806310A	816310A		1/4"	128	90	63	16	19	3700 KG	15,0
806311A	816311A		1/4"	133	95	68	16	19	3700 KG	15,0
806312A	816312A		1/4"	145	107	80	16	19	3700 KG	17,5
800712A	810712A	7	9/32"	162	107	80	18	22	5600 KG	17,5
800812A	810812A	8	5/16"	162	107	80	19	24	5600 KG	17,5
800816A	810816A	8	5/16"	182	133	100	19	24	5600 KG	40,0
809516A	819516A		3/8"	190	133	100	24	27	8000 KG	47,2
801016A	811016A	10	5/8"	190	133	100	24	27	8300 KG	47,2
801220A	811220A	12	3/4"	227	159	120	27	32	12000 KG	79,0
801320A	811320A		1/2"	227	159	120	27	32	13600 KG	79,0
801322A	811322A		1/2"	227	159	120	27	32	13600 KG	85,0
801422A	811422A	14	7/8"	264	191	140	30	36	17000 KG	124,0
801625A	811625A	16	1"	308	227	170	32	41	23000 KG	175,0

Note: All breakloads are determined by wedges (jaws) and thread.
The user is responsible for choosing the proper cable diameter and for correct assembly.



MARINE
RIGGING HARDWARE

SWAGELESS TOGGLE TERMINALS

High Polished Stainless Steel - AISI 316

Secure, reliable and tool free swaging of wire, with the fastest swageless system on the market. Ideal for emergency repairs and any other job which normally requires professional swaging.

ART. NO.	WIRE	L1	L2	L4	KW1	KW2	A	B	PIN SIZE	BL
830603	3,0	71	50	12,0	10	12	8	14	6,0	750 KG
830804	4,0 5/32"	90	61	15,0	13	14	10	18	8,0	1500 KG
831005	5,0	108	75	21,0	14	16	12	23	9,5	2180 KG
831106	6,0	125	88	23,0	17	19	15	30	11,0	3700 KG
831207	7,0 9/32"	140	100	24,7	18	21	18	30	12,7	4700 KG
831208	8,0 5/16"	148	102	23,7	19	24	18	30	12,7	5600 KG
831610	10,0	176	125	32,0	24	27	20	35	16,0	8300 KG
831912	12,0	206	138	36,0	27	32	24	40	19,0	12000 KG
832214	14,0	230	157	35,0	30	36	26	50	22,2	17000 KG
832516	16,0	261	180	40,0	32	41	29	60	25,4	23000 KG

Note: all breakloads are determined by clevis pin
The user is responsible for choosing the proper cable diameter and for correct assembly

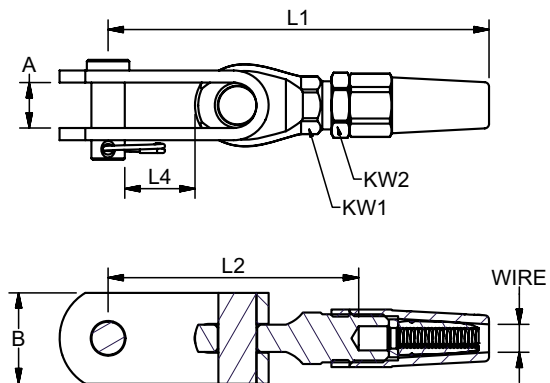

SWAGELESS EYE TERMINALS

High Polished Stainless Steel - AISI 316

ART. NO.	WIRE	L1	L2	L3	T	D	KW1	KW2	BL	KG/100
821903	3 1/18"	58	50	26,5	5,5	6,3	10	12	750	4,0
821904	4 5/32"	68	58	31,0	7	8,3	13	14	1500	7,3
821905	5 -	81	70	37,0	8	10,3	14	16	2180	9,8
821906	6 1/4"	97	83	45,0	9	13	17	19	3700	15,0
821907	7 9/32"	105	89	50,5	9	13	18	21	4700	21,2
821908	8 5/16"	121	103	52,5	10	14,5	19	24	5600	28,1
821910	10 -	135	116	65,0	13	16,2	24	27	8300	46,0
821912	12 -	160	137	71,5	15	19,5	27	32	12000	72,0
821914	14 -	185	160	85,0	18	22	30	36	14000	110,0
821916	16 -	197	170	98,0	20	25	32	41	23000	160,0

Note: All breakloads are determined by wedges (jaws) and eye (D2)
Assemble instruction look at page 29

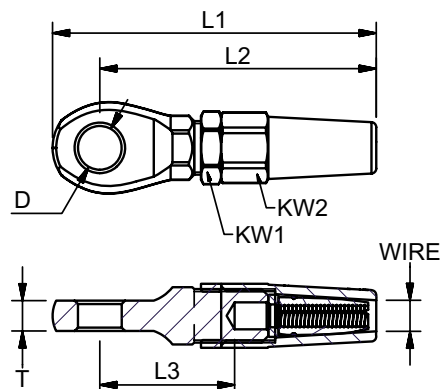



MARINE
RIGGING SYSTEM

SWAGELESS FORK TERMINALS

High Polished Stainless Steel - AISI 316

Secure, reliable and tool free swaging of wire, with the fastest swageless system on the market. Ideal for emergency repairs and any other job which normally requires professional swaging.

ART. NO.	WIRE	A	L1	L2	L3	L4	PIN SIZE	KW1	KW2	BL	KG/100
840603	3	6	63	55	29,0	8	6	14	12	750 KG	4,0
840632	1/8"	6	63	55	29,0	8	6	14	12	750 KG	4,0
840804	4 5/32"	8	73	62	35,0	8	8	19	14	1500 KG	7,3
841047	3/16"	10	83	72	42,0	10	10	22	16	2150 KG	9,8
841005	5	10	83	72	42,0	10	10	22	16	2180 KG	9,8
841255	7/32"	12	95	82	47,5	12	12	27	19	3000 KG	15,0
841206	6	12	95	82	47,5	12	12	27	19	3700 KG	15,0
841263	1/4"	12	95	82	47,5	12	12	27	19	3700 KG	15,0
841207	7 9/32"	12	115	102	54,5	13	12	29	22	4700 KG	21,2
841408	8 5/16"	14	118	103	58,0	14	14	30	24	5600 KG	28,1
841695	3/8"	16	135	117	70,0	16	16	36	27	8000 KG	46,0
841610	10	16	135	117	70,0	16	16	36	27	8300 KG	46,0
841912	12	18	162	142	75,0	16	19	42	32	12000 KG	72,0
841913	1/2"	18	162	142	75,0	16	19	42	32	13600 KG	72,0
842214	14	21	190	162	88,0	19	22	46	36	17000 KG	110,0
842516	16	23	217	184	102,0	22	25	55	41	23000 KG	160,0

Note: All breakloads are determined by wedges (jaws) and clevis pin
The user is responsible for choosing the proper cable diameter and for correct assembly

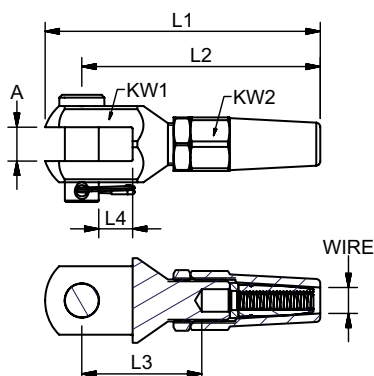

CLEVIS PINS

High Polished Stainless Steel - AISI 316

ART. NO.	L	D	KG/100	PACK
061605	15	5,0	0,30	BULK
061806	17	6,0	0,90	BULK
061663	16	6,35	0,90	BULK
061908	18	8,0	1,00	BULK
062008	21	8,0	1,10	BULK
062395	23	9,5	1,50	BULK
062611	26	11,0	2,40	BULK
062812	28	12,0	3,00	BULK
062813	28	12,7	3,50	BULK
063412	34	12,0	4,00	BULK
063214	33	14,0	5,30	BULK
063714	37	14,0	5,50	BULK
063416	34	16,0	6,50	BULK
064016	40	16,0	7,70	BULK
064419	45	19,0	13,00	BULK
064919	49	19,0	14,00	BULK
064622	46	22,0	16,30	BULK
065522	55	22,0	19,00	BULK
065822	58	22,0	20,00	BULK
065525	56	25,4	25,00	BULK
066325	63	25,0	28,00	BULK
067328	73	28,0	40,00	BULK
068332	83	32,0	60,00	BULK
068835	88,5	35,0	76,00	BULK

